

# DriverTest\_Factory User Manual

Document version : V1.0  
Update Date : 2022-1-25

## 一、 Main Page Function

Open the DriverTestFactory application and select the device model:



It will enter the main page after selecting the model:

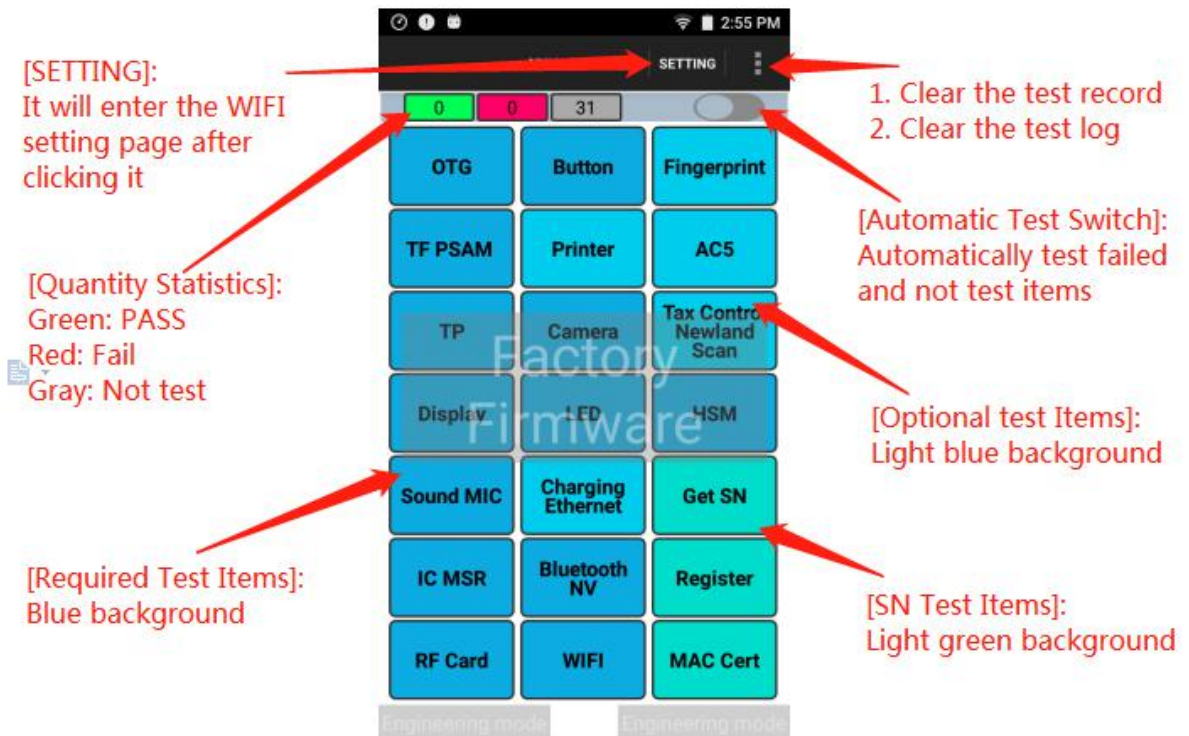

- **【SETTING】** : It will enter the WiFi settings page
- **【!】** : Clear the test record and the test log
- **【Quantity Statistics】** : Green, PASS ; Red, Fail ; Grey , Not Test
- **【Automatic Test Switch】**: Automatically test failed and not test items
- **【Required Test Items】**: Hardware required test items. blue background color
- **【Optional Test Item】**: Hardware optional test items. light blue background
- **【SN Test Items】** : Software processing items. light green background

## 二、Module Function

### 1、【OTG】

- Connect U disk and device by OTG port, if the device can read and write files from U disk, the testing item will pass automatically

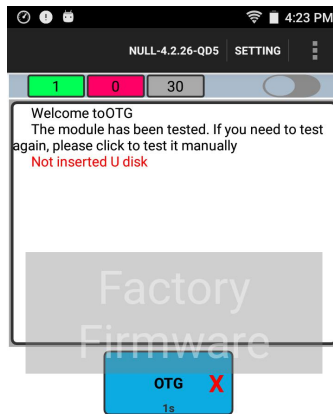

Engineering mode

Engineering mode

### 2、【TF/PSAM/SIM】

[TF Card]

- Insert the TF card into the device. If the device can read and write files from

TF card, the testing item will pass automatically

[PSAM Card]

- Insert the PSAM card into the device, and reboot it. If the device detect the PSAM card, the testing item will pass automatically

[SIM Card]

- Insert the SIM card into the device, and reboot it. If the device detect the SIM card can be used normally, the testing item will pass automatically
- ✧ Remark: SIM testing item is optional on Q4/Q5/Q3W, PSAM testing item is optional on Q3W

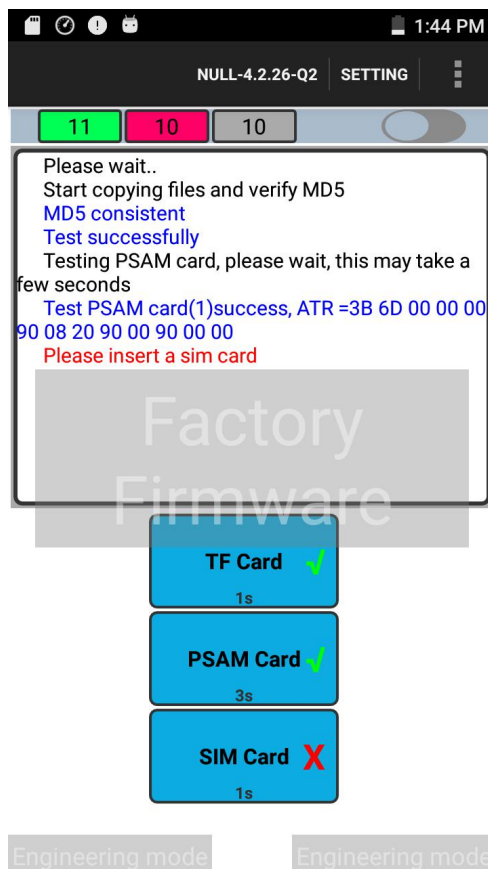

### 3、【TP】

- Press the preset point as prompted, if the TP (touch panel) is good, the testing item will pass automatically

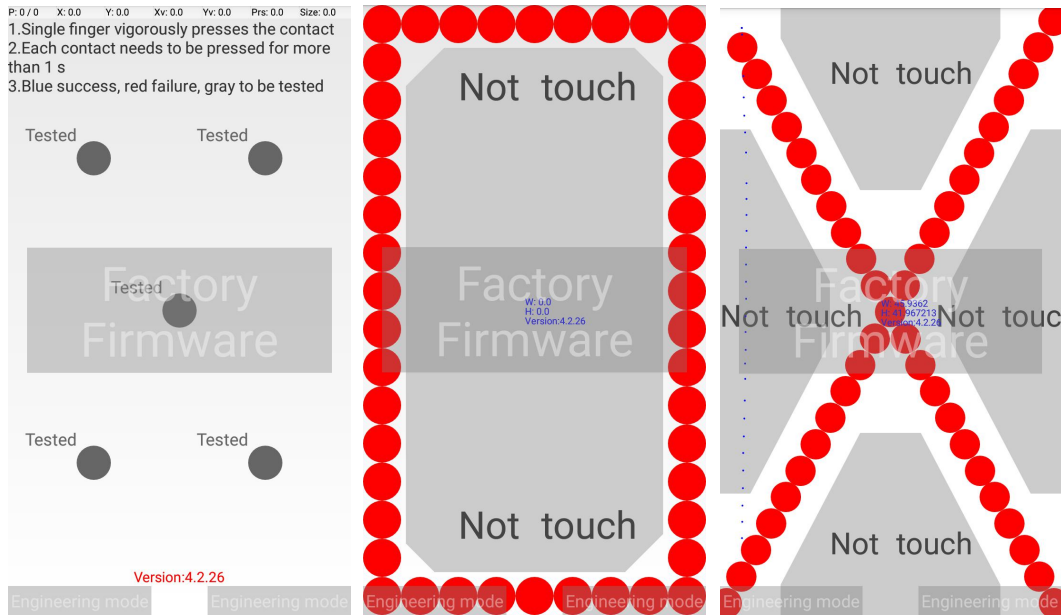

#### 4、【Display】

- Click the screen, it will automatically switch pictures to check whether there are bad spots and light leakage on the screen. The result need to be determined manually

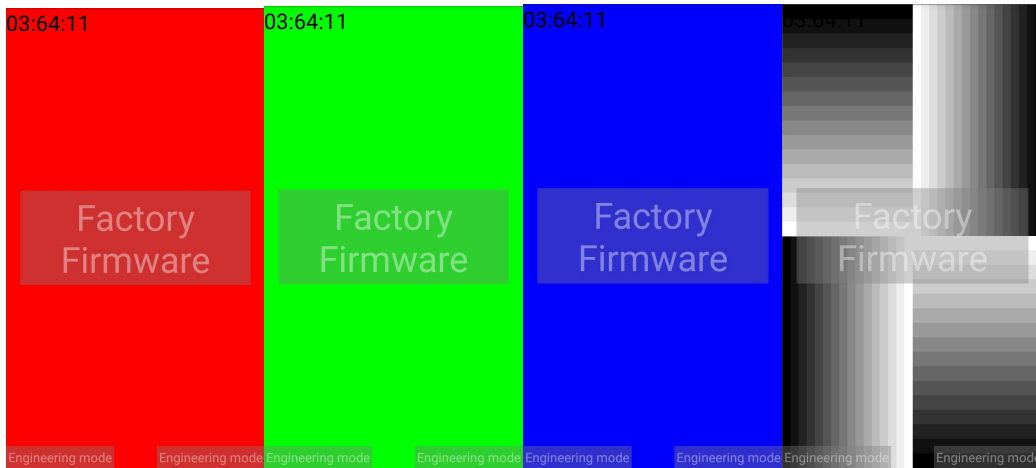

#### 5、【Sound MIC】

- Play an audio and record it at the same time, then play it out. Check whether there are two audio and whether the volume is higher than 50 dB. The result need to be determined manually

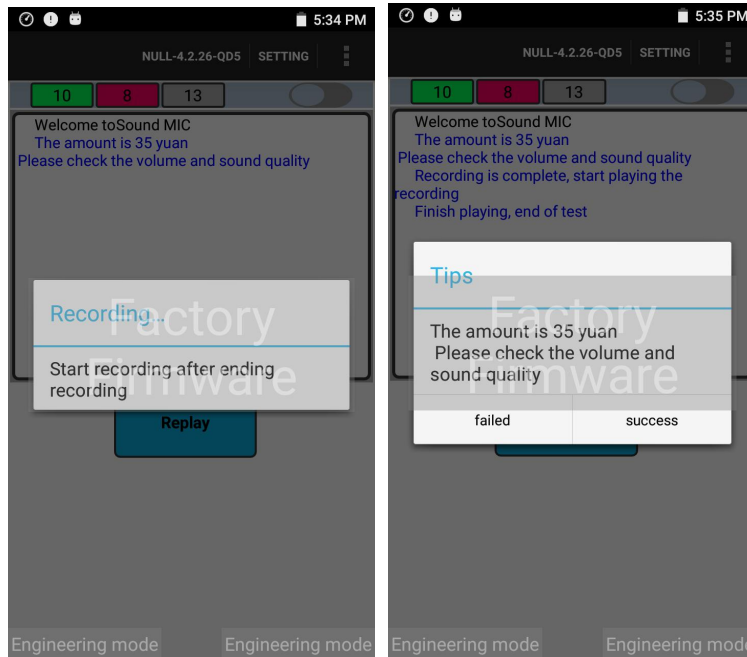

## 6、【IC/MSR】

### 【IC】

- Insert the IC card into the device at least 2 seconds and remove it. If the device can read the ATR of the IC card, the testing item will pass automatically

### 【MSR】

- Swipe the MSR along the slot. If the device can read the 3 tracks data for 3 times continuously, the testing item will pass automatically
- ✧ Remark: 【IC/MSR】 testing items is optional on K2



## 7、【RF Card】

- Place the contactless card 0cm and 4cm away from the card reader. If the device can read the CardID and APDU of the contactless card for 5 times continuously at 0cm and 4cm respectively, the testing item will pass automatically

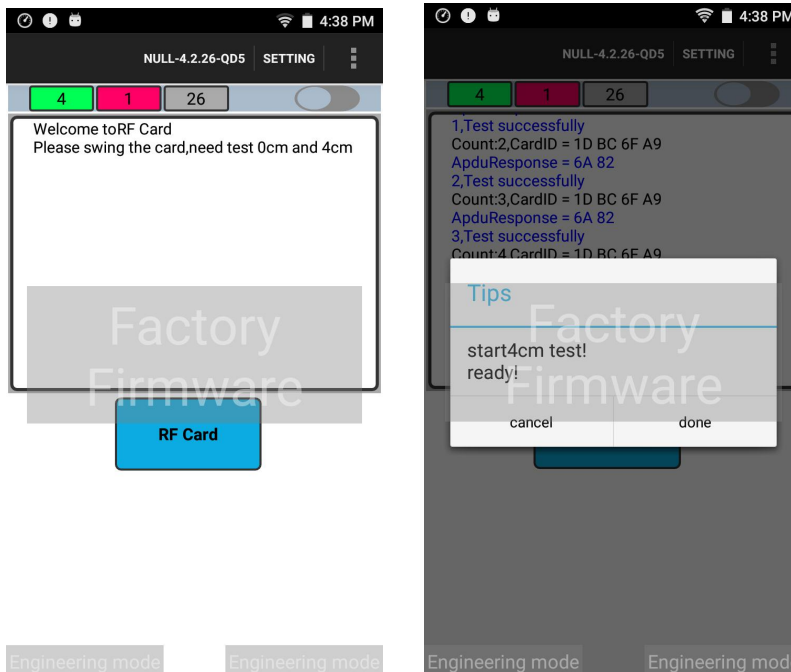

## 8、【Button】

- Press each physical button at least twice. If each button works well, the testing item will pass automatically
- ✧ Remark: Different types of the device have different button positions and numbers

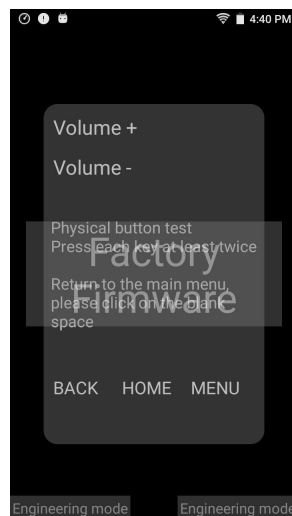

## 9、【Printer】

- Check whether the printer is normal by printing a receipt. The result need to be determined manually
- ✧ Remark: It is an optional test item on Q5/Q3A7/Q3W

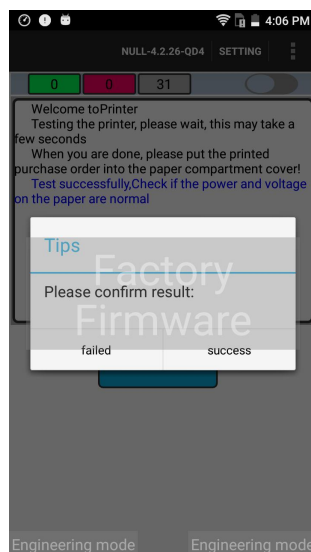



## 10、【Camera】

- Check the resolution and zoom function of the camera by scanning the QR code. If the camera works well, the testing item will pass automatically (Please refer to the attachment for the QR code )

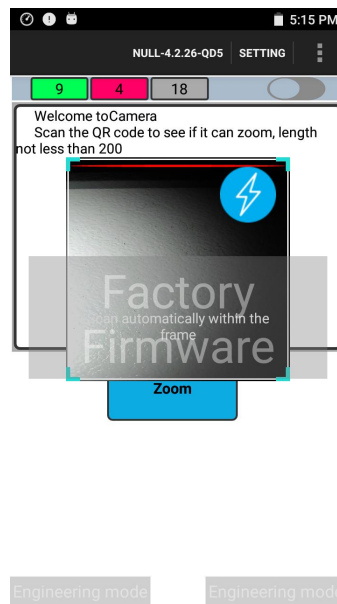

## 11、【LED】

- Check whether the 4 LED lights flashes alternately. The result need to be determined manually

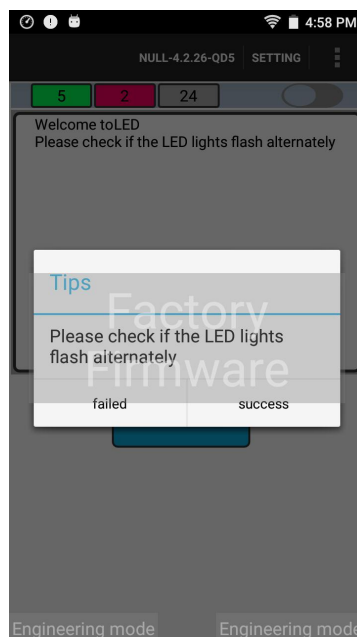

## 12、【Charging/Ethernet】

### 【Charging】

- Check whether the device can be charged normally and whether the battery voltage is normal. If everything is OK, the testing item will pass automatically

### 【Ethernet】

- Check the Ethernet MAC address and whether the Ethernet network is available. If everything is OK, the testing item will pass automatically
- ✧ Remark: Only Q4/Q5/Q6 need to test the item

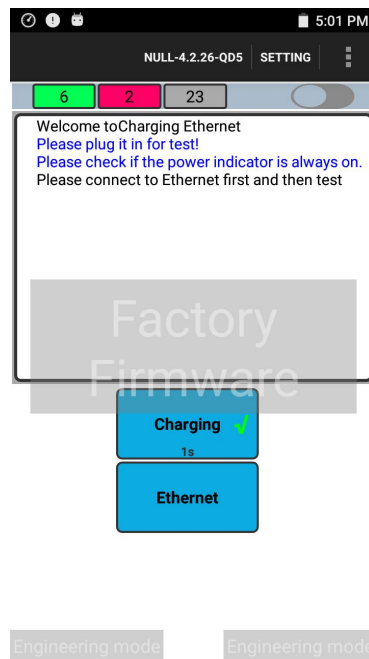

## 13、【Bluetooth/NV】

### 【Bluetooth】

- Check whether Bluetooth is available through search other device. If the device can detect successfully, the testing item will pass automatically

### 【NV】

- Check whether the device has a preset NV value, If not, it will check the number of modem restarts within 10 minutes. If the NV value is detected or the number of restarts is less than 2 times, the testing item will pass automatically ( NV is the RF calibration parameter of the device )



## 14、【WIFI】

- Check whether WiFi is available. If the network is normal, the testing items will pass automatically

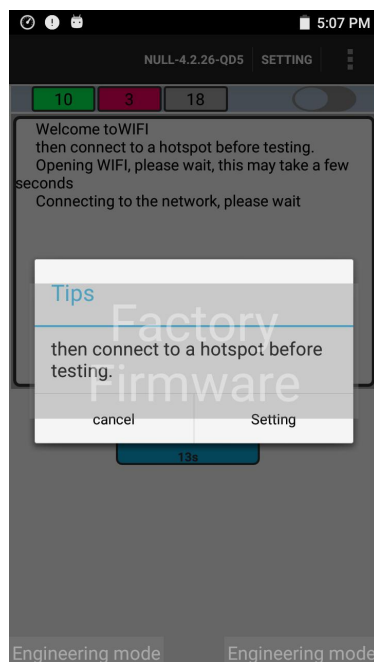

## 15、【Fingerprint】

- Press the fingerprint module with your finger according to the prompt. if the device get the fingerprint information, the testing items will pass automatically
- ✧ Remark: It is an optional test item

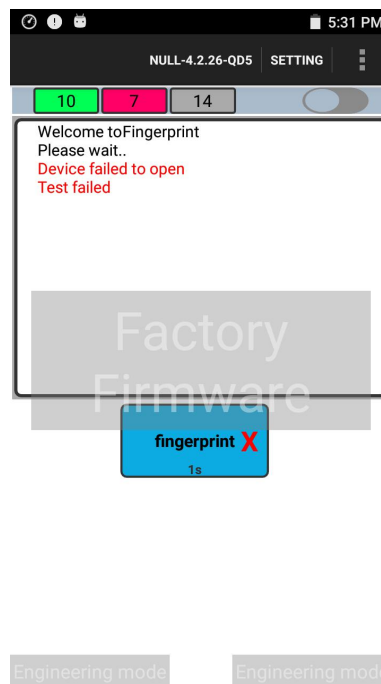

## 16、【AC5】

- Check whether the SM4 hardware exists. If the device invoke the interface successfully , the testing items will pass automatically
- ✧ Remark: It is an optional test item

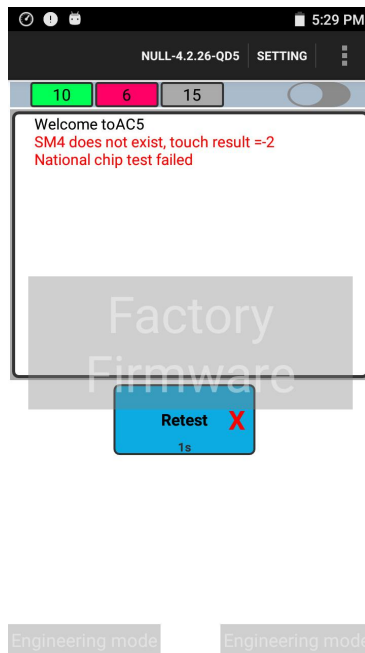

## 17、【Tax Control/Newland Scan】

### 【Tax Control】

- Check whether the data written and read by the tax control module is same.

If the data is same, the testing items will pass automatically

### 【Newland Scan】

- Check the resolution of the Newland Scan by scanning a 5cm / 15cm / 20cm QR code. If the device can scan the QR code successfully, the testing items will pass automatically (Please refer to the attachment for the QR code)
- ◇ Remark: 【Tax Control/Newland Scan】 is an optional test item

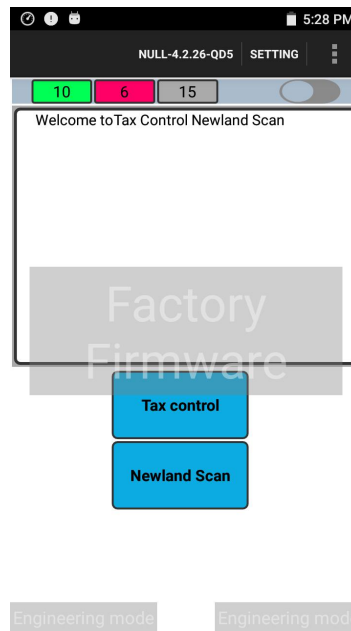

## 18、【HSM】

- Check the security module version of the device and whether it is enabled.  
If it can be enabled successfully, the testing items will pass automatically
- ✧ Remark: If the security module is not enabled, it needs to be enabled manually( K2 does not need to be enabled )

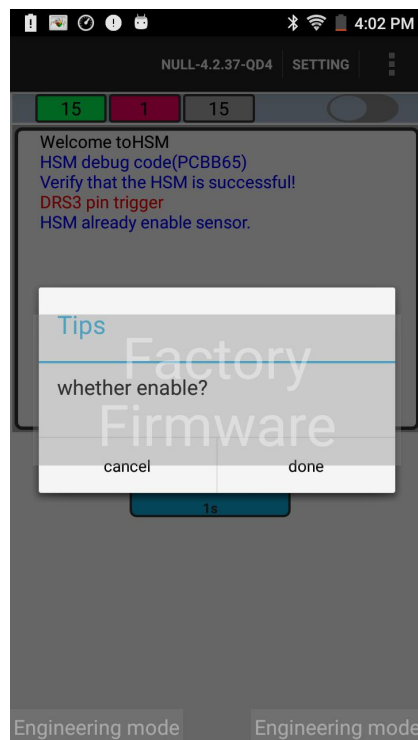

## 19、【Get SN】

- Scan the order QR code, it will request SN, IMEI, MEID etc. from TMS and write them into the device. If they can be written successful, the testing items will pass automatically



## 20、【Register】

- Check whether the device register the TMS(Terminal Manager System). If it registered the TMS successfully, the testing items will pass automatically

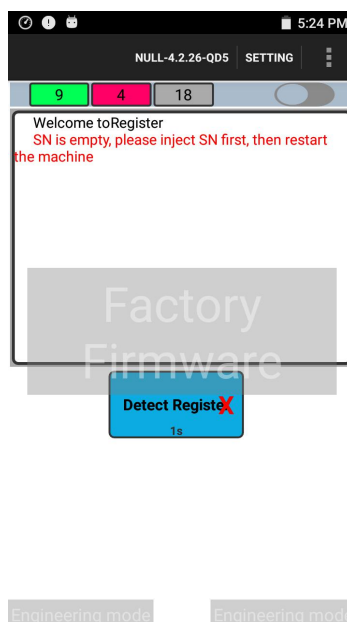

## 21、【MAC/Cert】

### 【MAC】

- Check whether the value of IMEI/MEID/WIFI MAC/BT MAC/Battery SN in the device are duplicated. If not duplicate, the testing items will pass automatically
- ✧ Remark: IMEI and MEID are global check, others are batch check

### 【Cert】

- Check whether the Agent/Pinpad certification exist. If exist, the testing items will pass automatically

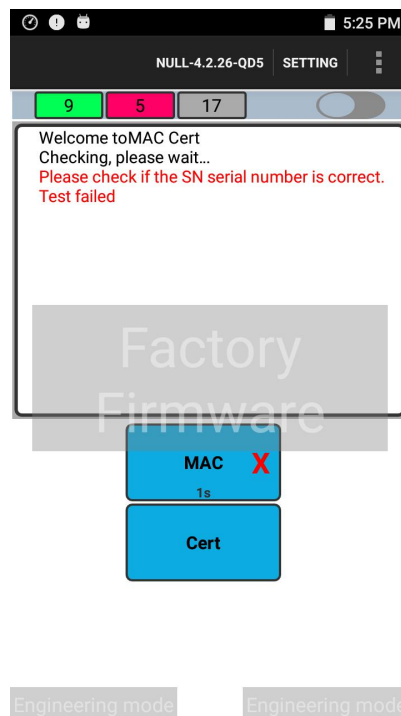



Camera test QR code



**Zoom test**

### Newland Scan test QR code



5cm



15cm



20cm