

## Q1

All-in-One Handheld  
Smart POS



payWave



MasterCard TQM

paypass

expressPay

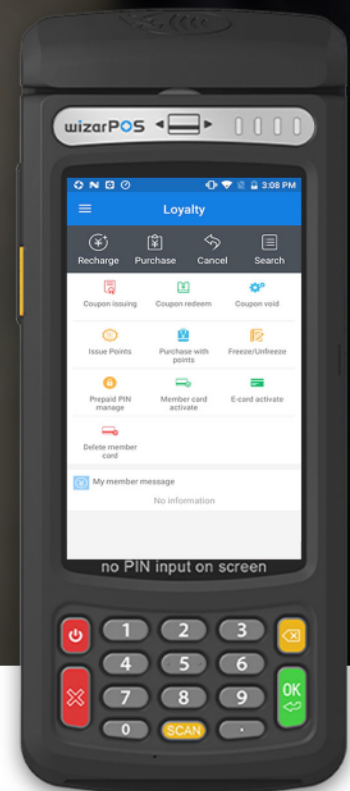

- Omni-channel acceptance (swipe, chip, contactless, eWallet, pre-paid, barcode, and biometrics)
- Hassle-free mobile transaction experience through a touch screen and long battery life
- Versatile wireless connection options (GSM, WCDMA, LTE, Wi-Fi, and Bluetooth)
- Heavy-duty design for harsh or rugged environments

*WizarPOS, the trailblazer in Android POS terminal technology, is committed to empowering secure, future-proof, and scalable payment solutions worldwide.*

## Q1 Technical Specifications

Software Platform	Secure Android 7.1
Security	PCI PTS 4.X, SRED
Processor	Quad-Core @ 1.1GHz
Memory	1 GB RAM, 8 GB Flash or 2G RAM,16GB Flash
Display	4" multi-touch color LCD panel (800 x 480)
Printer	High-speed 58 mm thermal printer
Biometrics	Capacitive fingerprint sensor (optional) option 1: 20 × 32 mm, 500 DPI, fake fingerprint detection, ISO19794-2 option 2: 20 × 32 mm, 508 DPI, supporting ANSI-378 & ISO19794-2 (FBI, FIPS201, and STQC certified) Facial recognition (Optional)
Camera	5-megapixel camera with autofocus and flash
Scanner	2D barcode scanner Zebra barcode scanner (optional)
Contactless	ISO 14443 Type A & B, MIFARE, Contactless EMV Level 1, MasterCard PayPass, Visa payWave, America Express Expresspay, Discover D-PAS, UnionPay Quickpass, Wise
Chip Card	ISO 7816, EMV Level 1 & Level 2
MSR	ISO7811, Track 1/2/3, bi-direction
Slots	1 SIM & 1 SAM, 1 TF card (up to 64GB)
Communications	GSM, WCDMA, FDD-LTE, TDD-LTE, Wi-Fi, Bluetooth 4.0 e-SIM (optional)
Satellite Positioning	GPS, GLONASS
USB	micro-USB OTG, USB 2.0 HS compliance
Battery	10 hours per charge
Dimensions	183 x 76 x 50 mm (7.2 x 3.0 x 1.97 inches)
Weight	450 g (1 lb)

All features and specifications are subject to change without notice. Contact WizarPOS sales for more details.

